

Castlebrooke Secondary School

Peel District School Board / CS&P Architects
10 Gardenbrooke Trail, Brampton Ontario

New Building, Institutional - A.4.4

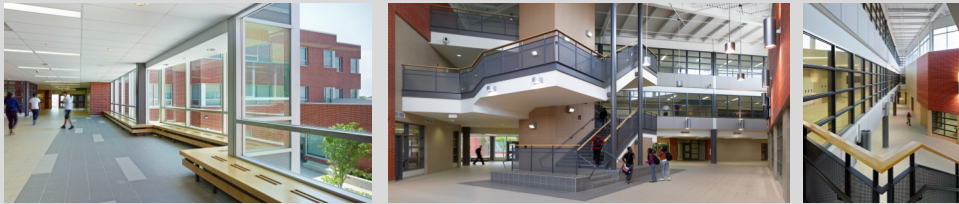

Designed to respond to the needs of a large and rapidly growing community in northeast Brampton, the new 3-storey, 19,300 m² Castlebrooke Secondary School accommodates 1800 students. The 6.4 hectare site offered the potential to be a gateway to the new neighbourhood and a large landscaped entry feature is incorporated on the site as a strong urban presence on The Gore Road.

The site and school planning embodies a number of important urban design features.

- Vehicle and pedestrian entry to the site is all from the collector street, Gardenbrooke Trail.
- The school is clearly oriented to front onto this street to create a welcoming main entry transition.
- Vehicle access is aligned with the local residential streets, for ease of circulation and safety.
- Traffic organization separates car and bus drop off areas, as well as visitor, staff and student parking zones to promote safety and efficiency.
- Public and community use components of the program, the central atrium, library, cafeteria and gyms form the public face of the school, are all fronting on to the main pedestrian entry plaza, and are easily accessible for community use.
- The large mass of the school is articulated into smaller identifiable volumes which reflect the program uses. Building height steps up from one storey at the front to three at the rear, to reinforce this articulation. Two brick colours and aluminum curtain wall cladding serves to further reduce the building mass.
- All classroom teaching areas are oriented to the quieter northern part of the site.
- A unique courtyard design, between three classroom pods, ensures that all teaching spaces have access to daylight.